



Rear Trailing Arm Bushing Installation Tool - Instructions for use

Assembly #: 2020904 - 911 / 912 / 930

Cars applicable:

911 / 912 / 930 - Rear Trailing Arm Bushing

Parts list:

P/N: 2020904	
Description	Quantity
Cup	1
Piston	1
M14 Threaded Rod	1
M14 Hex Nut	2
M14 Standard Flat Washer	2

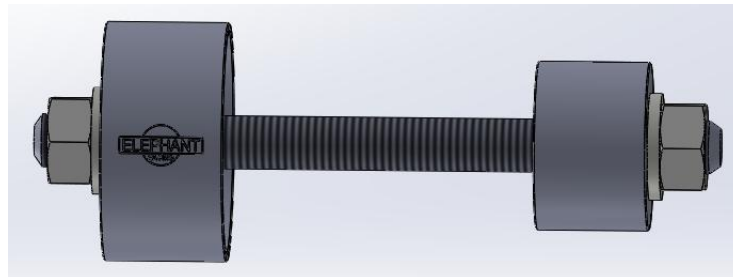

Bushing Installation Tool Assembly

Tools Required:

- 22mm deep socket
- 22mm wrench

Introduction:

We understand that the task of installing new bushings or monoballs into your control arms can be a daunting task. That's why Elephant Racing has devised a set of tools to make installing your new inserts simple and easy. When used in conjunction with the Bushing Removal Tool from Elephant Racing (P/N: 2020903), there's no need to remove the control arm or trailing arm completely from the vehicle!

Step-by-Step Instructions:

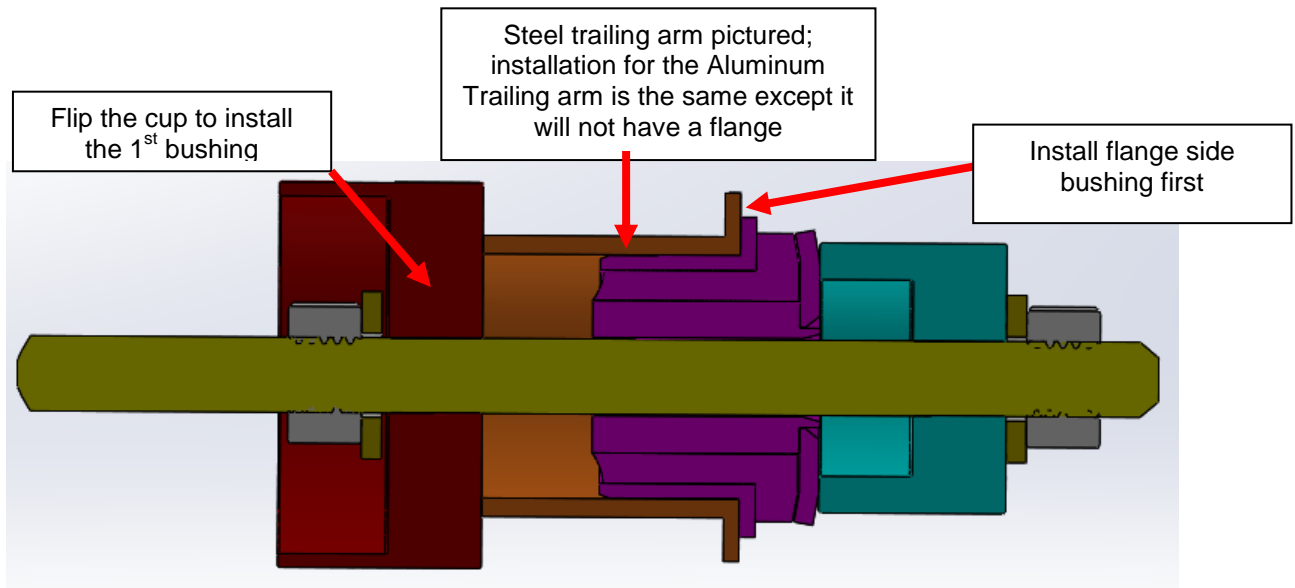

Figure 1: Installation Tool and Bushing Install 1st bushing

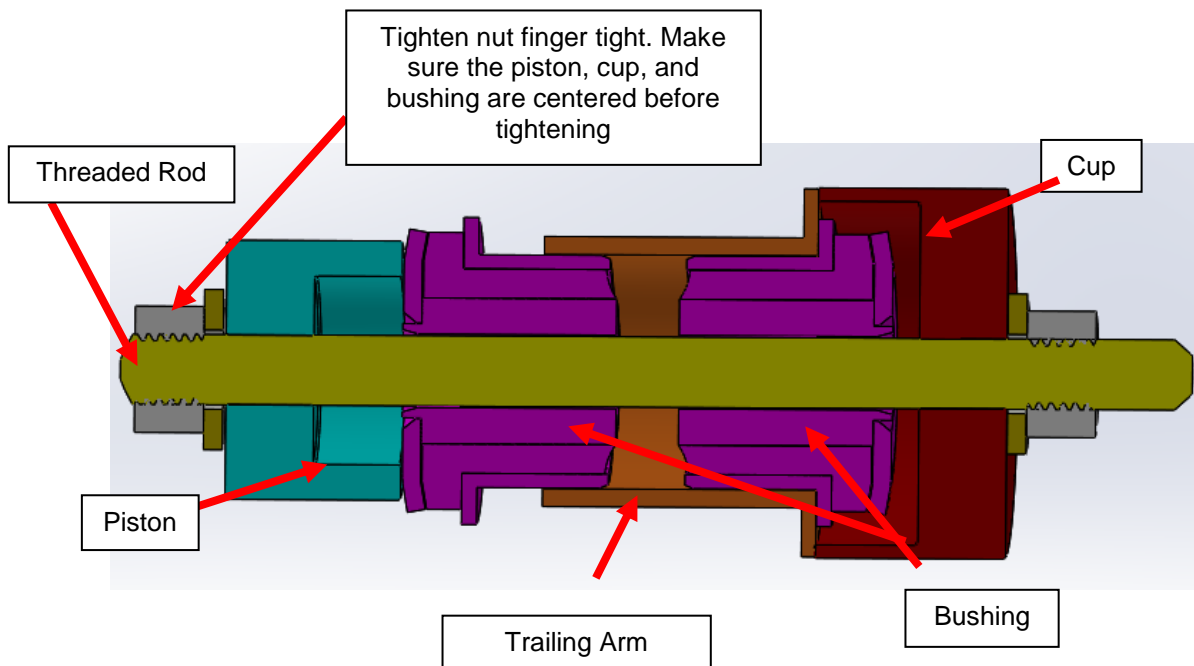

Figure 2: Installation Tool and Bushing/ Installation of 2nd bushing



1 – Remove the bushings from the control arms or trailing arms that are going to be replaced. Elephant Racing recommends using the Elephant Racing Bushing Removal Tool (P/N: 2020903), to aid in bushing extraction.

2 – Slide the threaded rod through the piston, bushing, and cup. Install the nuts and washers on either side of the assembly and tighten finger tight; See Figure 1.

Figure shows a 911 steel Trailing Arm; installation instructions are the same for an Aluminum Trailing Arm

Install 1st bushing on the side with the flange as shown in figure 1

3 – Use two wrenches to tighten the nuts. Ensure the bushing is concentric as it is drawn into the control arm or trailing arm. Continue tightening the nut until the bushing flange contacts the control arm or trailing arm.

4 – Repeat steps 3 and 4 to install the second bushing half in the control arm or trailing arm as seen in figure 2. Reattach the control arm or trailing arm and torque all fasteners as called out in an approved shop manual.

5 – Reattach the control arm or trailing arm and torque all fasteners as called out in an approved shop manual.



This page was left intentionally blank.